Sensing City: Public View

Ronald Rael and Greg Niemeyer

How do objects shape space?



Function of the object



Location of the object



Sign/Symbolic Meaning of object

How does data make place?



Languages of New Media

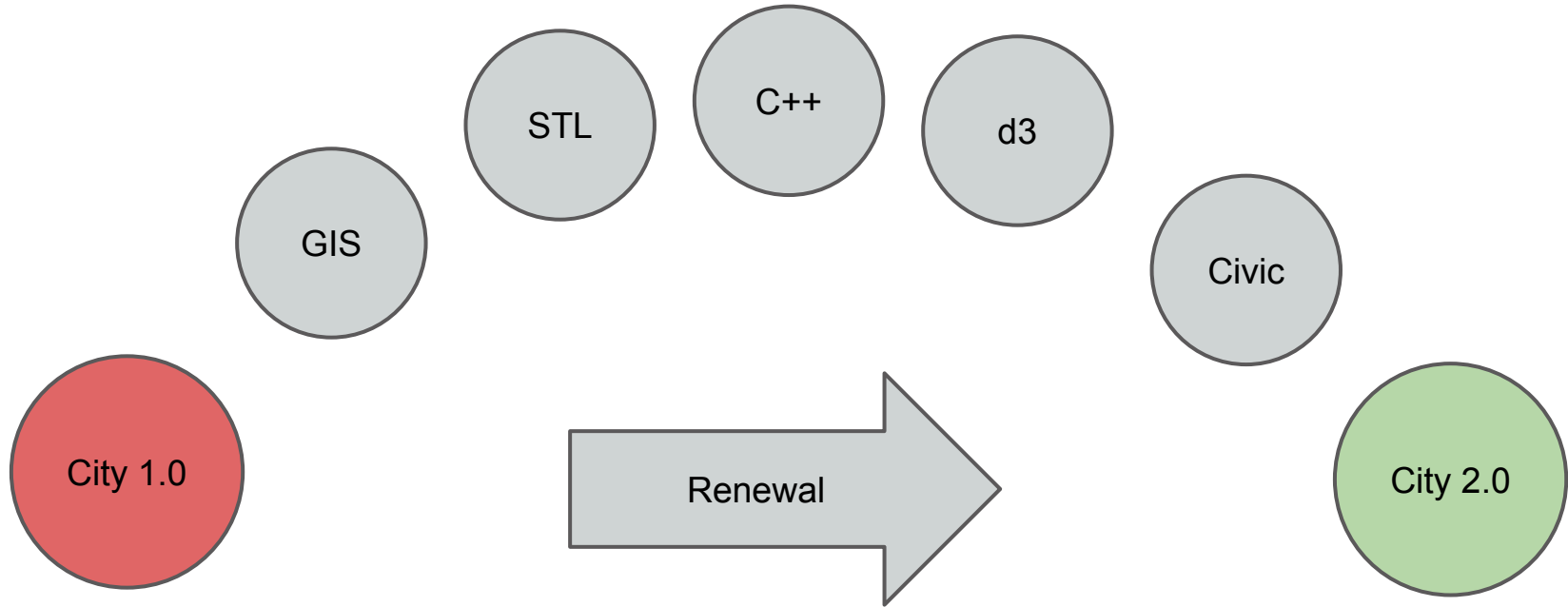

Flowchart

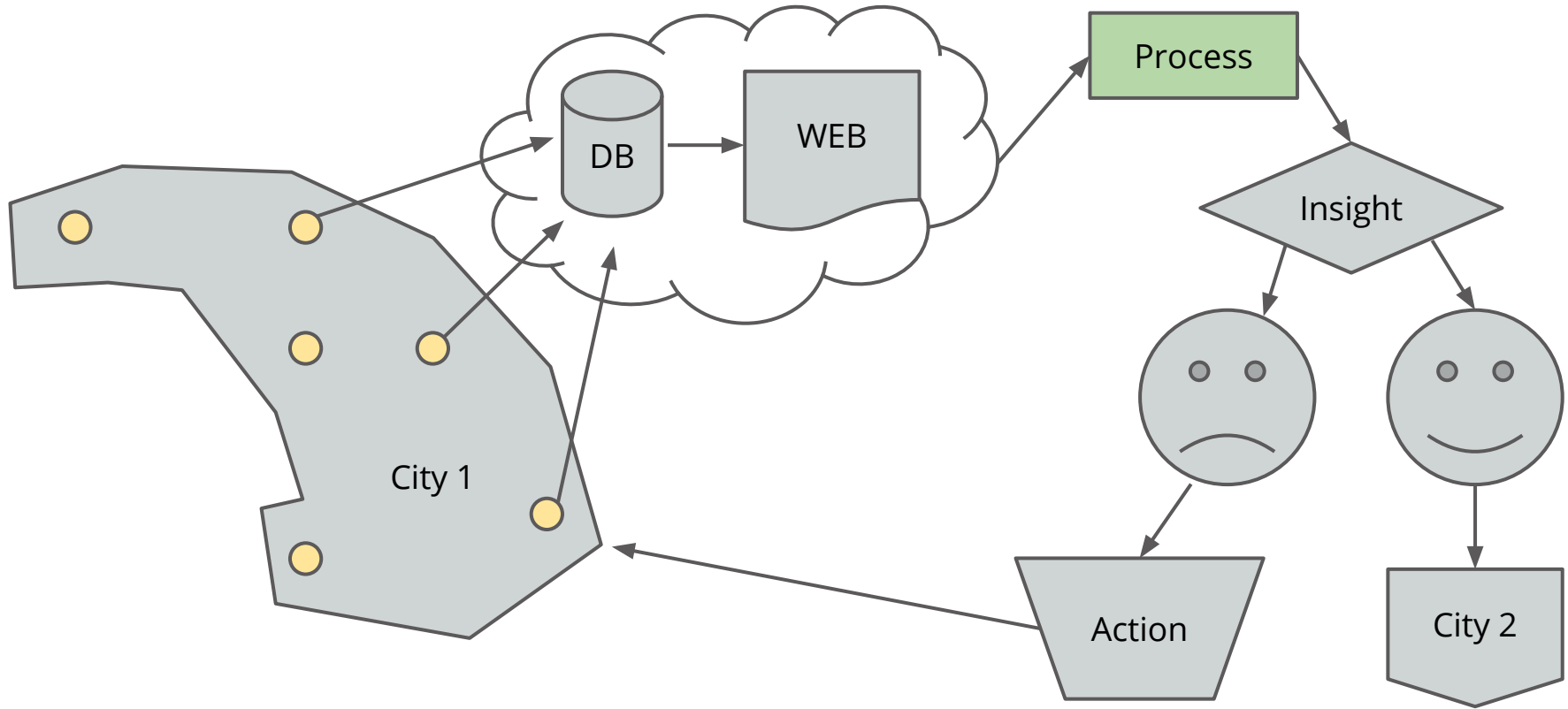

Sites of Latent Potential

A photograph of a dirt path leading through a dense forest. The path is illuminated by sunlight filtering through the trees, creating a bright area in the distance. The surrounding foliage is lush and green, with some trees having thick trunks. The overall atmosphere is serene and natural.

San Leandro Creek

Group 1: San Leandro Immersion (Sensing Cityscapes)

This is a map of group 1's walk through San Leandro Creek, and of some of the things we



☒ Will's Photos

- Our Path
- 1. Desire Path
- 2. "No Outlet" Sign
- 3. Footbridge Approach
- 4. Urban Forest
- 5. Private Yard
- 6. Under the Bridge
- 7. The Regulars
- 8. Unused Ramp
- 9. Public Housing
- 10. Log Bench
- 11. Tagged Drain
- 12. Locking Gate
- 13. Graffiti + Mural
- 14. Parking Lot

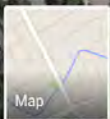

6. Under the Bridge



A cavernous space, formerly filled with murals, now painted bright green by the city up beyond the height of past graffiti. This site has a lot of potential, but it is also associated with danger and crime in many peoples' eyes. If we install a sensor here, there will be complex issues of privacy and surveillance to contend with (when people make their home in public, where does the private sphere begin?). At least we would know what color to 3D print in though!

Photo: https://lh5.googleusercontent.com/-3KIA9AiO_KA/VA3342wp1ml/AAAAAAAAAh/LLRDmME4PFA/w1582-h1186-no/photo%2B4.JPG

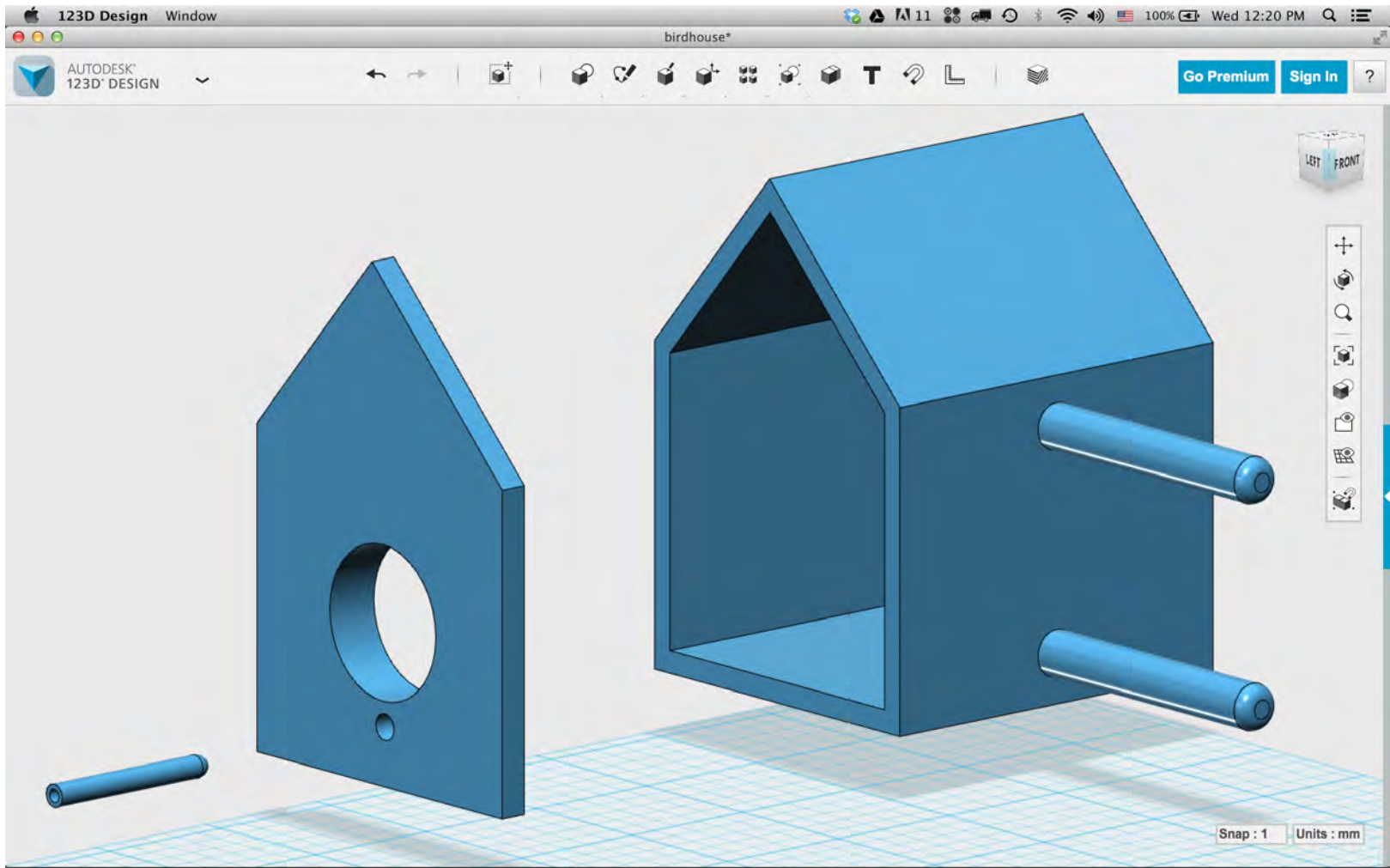

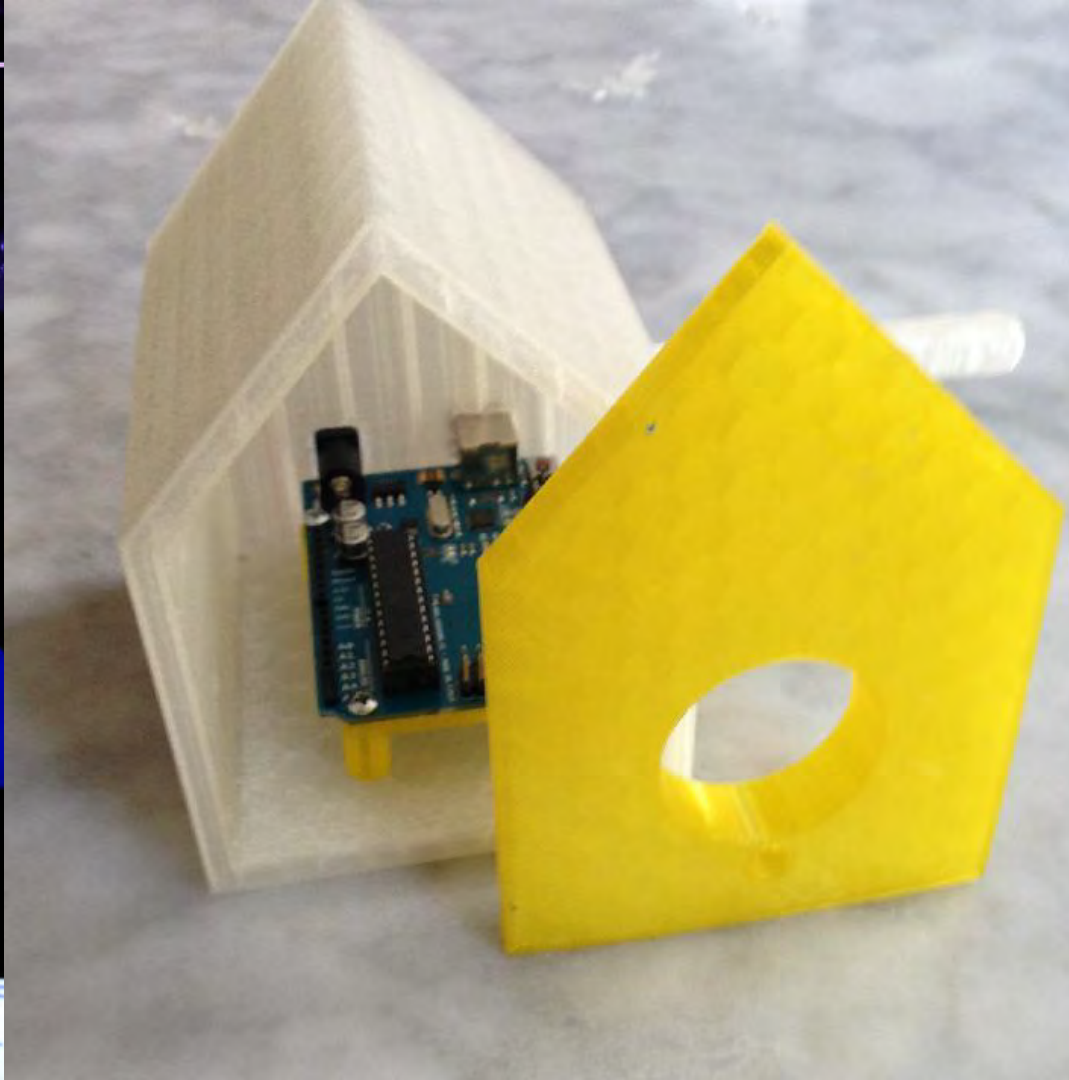
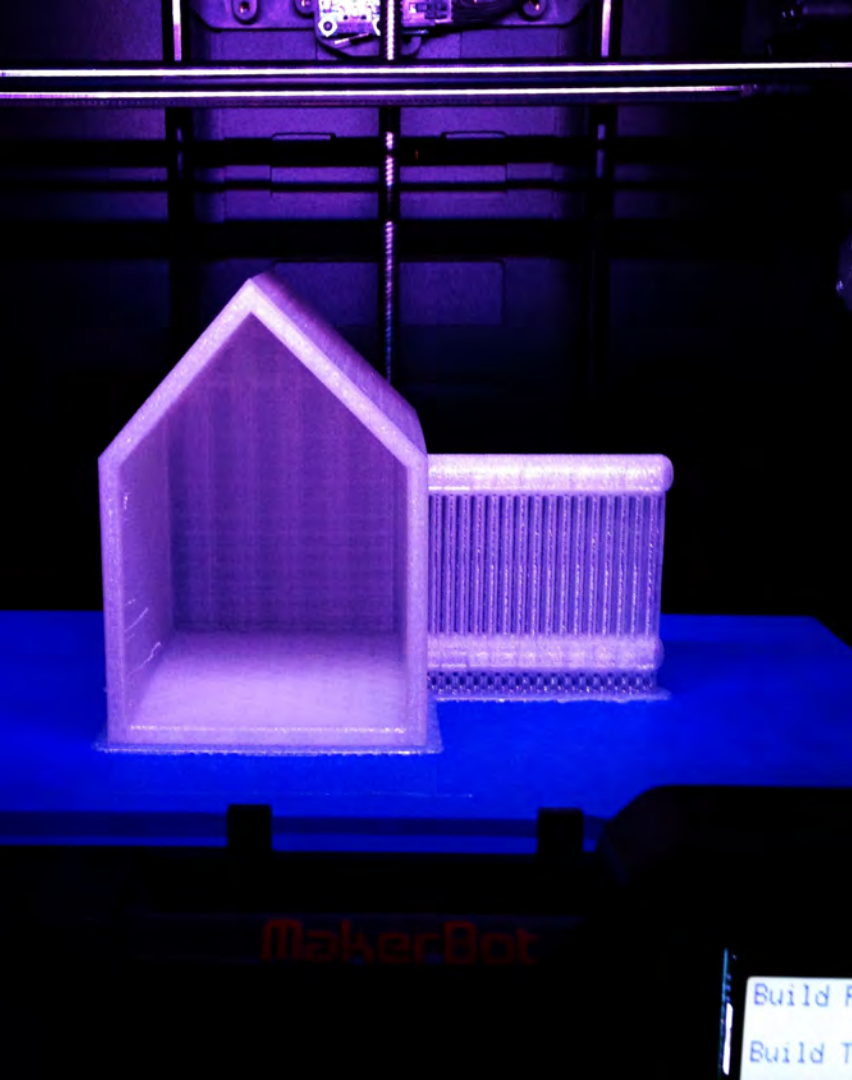



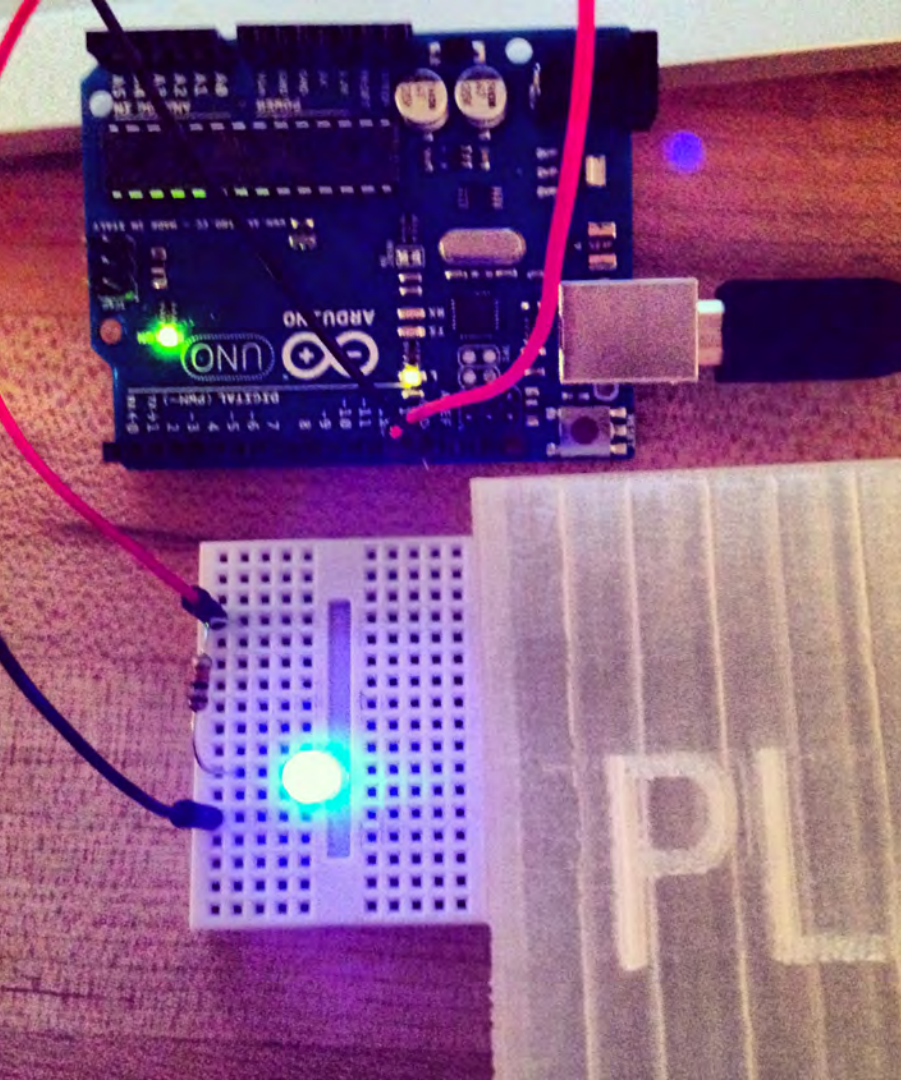

Hi Project: Sensing Foot Traffic

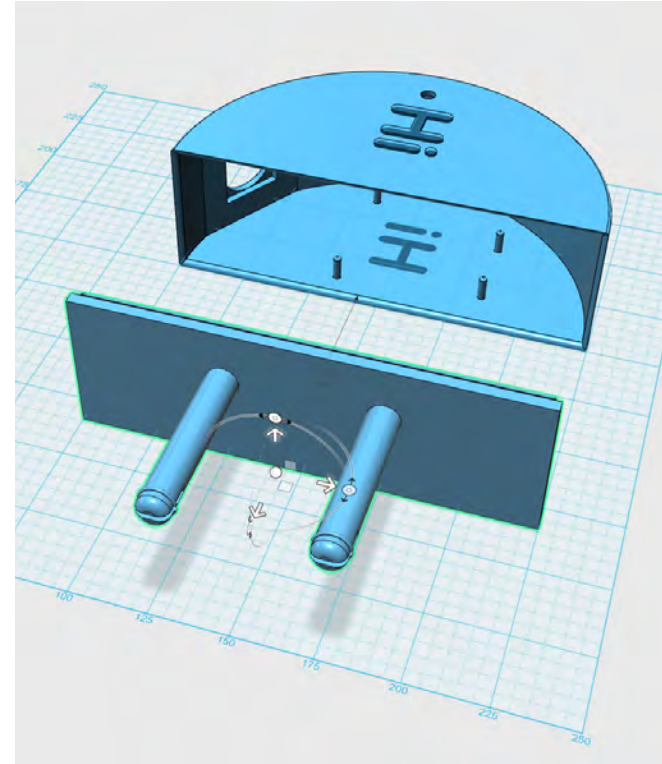
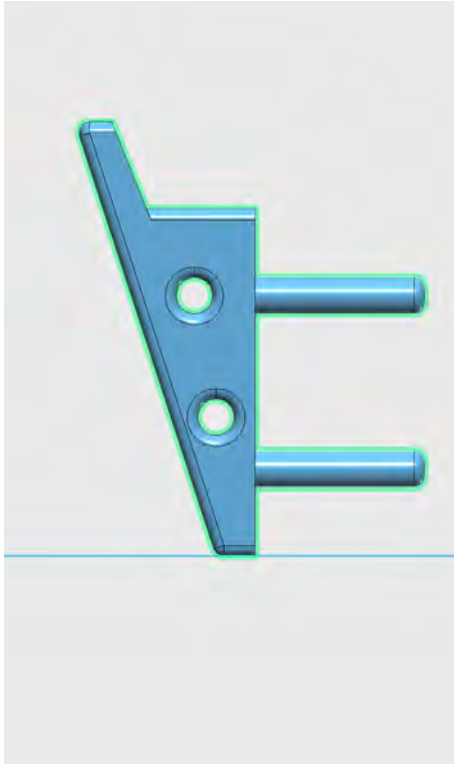

Hi Project: Sensing Foot Traffic

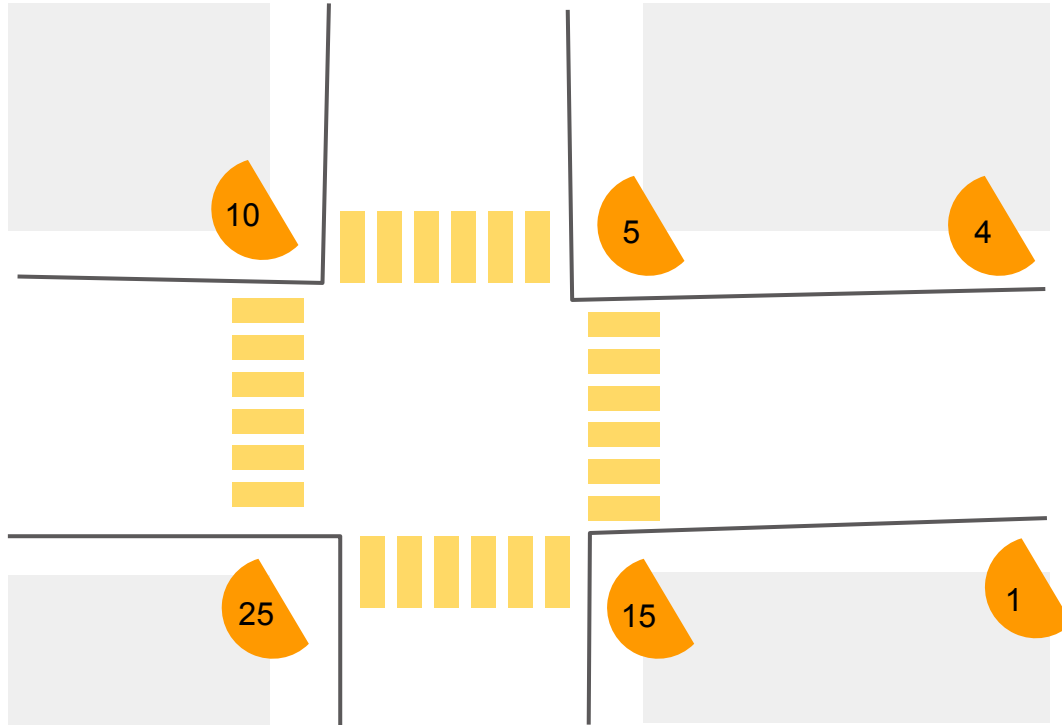

Hi Project: Public View

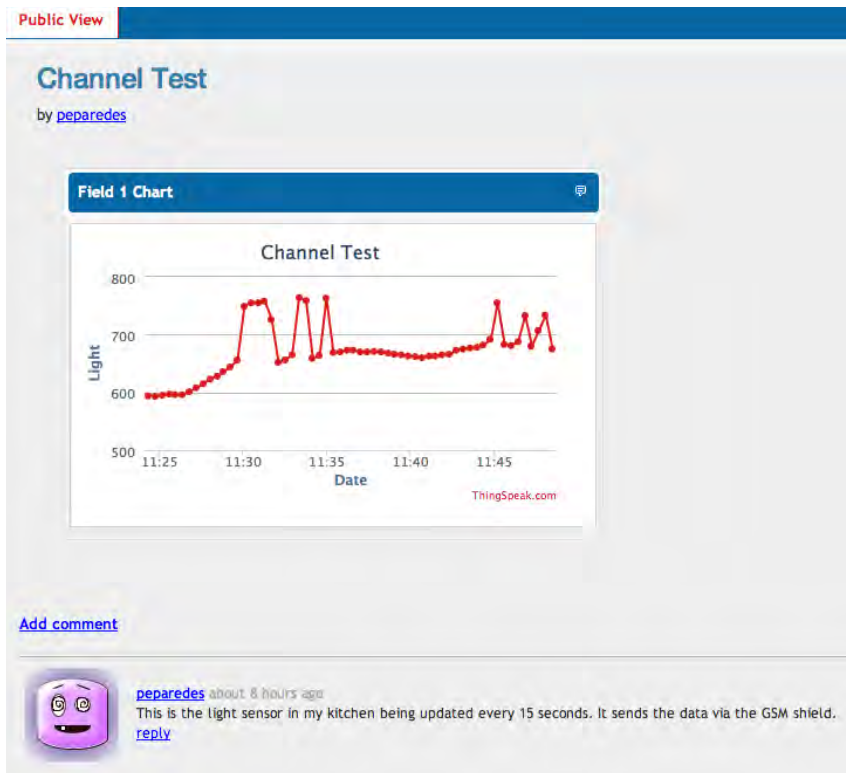

Hypothesis-free approach:

- Know everything and make that knowledge public
- Users will decide what data is useful for which actions
- Unintended side effects
- More risk, less impact.

Hypothesis-driven approach:

- Where is the action potential?
- What data can convert that action potential into specific projects?
- What data can help us validate the impact of these projects?
- Unnecessary limitations
- Less risk, more impact.